

KOKKATA UNUSANN CORPORATION  
 BUILDING IDENTIFICATION  
 PLANS APPROVED UP TO 30.08.2019  
 P. NO. 1234/2019/1000/01/2019  
 Approved Engineer  
 B.S. Prabhakar

This plan is for the construction of  
 a 4-story residential building.  
 B.S. Prabhakar  
 Date: 11/11/19  
 Ex. Engineer (S)

A. STAMP FOR K.M.C.



- B. GENERAL NOTES:  
 1. ALL DIMENSIONS ARE IN MILLIMETERS UNLESS OTHERWISE SPECIFIED.  
 2. WALL THICKNESSES ARE 150MM FOR EXTERNAL WALLS AND 100MM FOR INTERNAL WALLS.  
 3. ALL EXTERNAL WALLS ARE 200 THK & INTERNAL PARTITION WALLS ARE 125 THK UNLESS OTHERWISE MENTIONED.  
 4. ALL ELECTRICAL AND PLUMBING WORKS ARE CONSIDERED AS PER IS CODE.  
 5. TOILETS ARE VENTILATED BY MEANS OF MECHANICAL VENTILATION WHERE NATURAL VENTILATION IS NOT POSSIBLE.
- C. SCHEDULE OF DOORS, WINDOWS & FIXED GLAZING:

SCHEDULE OF DOORS:

DOOR TYPE	WIDTH (mm)	HEIGHT (mm)	LINTEL (mm)
D01	900	2100	2150
D02	900	2100	2150
D03	900	2100	2150
D04	900	2100	2150
D05	900	2100	2150
D06	900	2100	2150
D07	900	2100	2150
D08	900	2100	2150
D09	900	2100	2150
D10	900	2100	2150
D11	900	2100	2150
D12	900	2100	2150
D13	900	2100	2150
D14	900	2100	2150
D15	900	2100	2150
D16	900	2100	2150
D17	900	2100	2150
D18	900	2100	2150
D19	900	2100	2150
D20	900	2100	2150

SCHEDULE OF WINDOWS:

WINDOW TYPE	WIDTH (mm)	HEIGHT (mm)	SILL (mm)	LINTEL (mm)
W01	1200	1500	100	1500
W02	1500	1200	100	1200
W03	1500	1200	100	1200
W04	1500	1200	100	1200
W05	1500	1200	100	1200
W06	1500	1200	100	1200
W07	1500	1200	100	1200
W08	1500	1200	100	1200
W09	1500	1200	100	1200
W10	1500	1200	100	1200
W11	1500	1200	100	1200
W12	1500	1200	100	1200
W13	1500	1200	100	1200
W14	1500	1200	100	1200
W15	1500	1200	100	1200
W16	1500	1200	100	1200
W17	1500	1200	100	1200
W18	1500	1200	100	1200
W19	1500	1200	100	1200
W20	1500	1200	100	1200
W21	1500	1200	100	1200
W22	1500	1200	100	1200
W23	1500	1200	100	1200
W24	1500	1200	100	1200
W25	1500	1200	100	1200
W26	1500	1200	100	1200
W27	1500	1200	100	1200
W28	1500	1200	100	1200
W29	1500	1200	100	1200
W30	1500	1200	100	1200

\* ARTIFICIAL LIGHTING AND MECHANICAL VENTILATION  
 Per EMPORIS PROPERTIES PVT. LTD.  
 as per copy submitted by the client.  
 (Sealed stamp)

SUBJECT MATTER: CIVIL ENGINEERING  
 GUARANTEEOR OF EMPORIS PROPERTIES PVT. LTD.  
 CERTIFICATE OF STRUCTURAL ENGINEER

THIS IS TO CERTIFY THAT THE STRUCTURAL DESIGN AND DRAWING OF BOTH FOUNDATION AND SUPER STRUCTURE OF THE BUILDING HAS BEEN MADE BY ME AND THAT THE SAME IS IN ACCORDANCE WITH THE REQUIREMENTS OF THE NATIONAL BUILDING CODE OF INDIA AND CERTIFIED THAT IT IS SAFE AND STABLE IN ALL RESPECTS.

SANJAY K. P. (P)  
 M.S. No. 2019/JE/2503/19  
 Registration No. 1903000190  
 P.E. No. 2019/JE/2503/19

SIGNATURE OF STRUCTURAL ENGINEER  
 SANJAY PAREKH (ESE/10/14)

CERTIFICATE OF ARCHITECT  
 I DO HEREBY CERTIFY WITH FULL RESPONSIBILITY THAT THE BUILDING PLAN HAS BEEN PREPARED BY ME OR UNDER MY CLOSE PERSONAL SUPERVISION AND THAT THE PLAN IS A BUILDABLE SITE NOT A TANK OR FILLED UP TANK. THE SITE PLAN LOCATION PLAN AGREES WITH THE SITE. THE PLOT IS DEMARCATED BY BOUNDARY WALLS & MEASUREMENTS TALLY WITH THE REGD. DEED PLAN.

VIVEK SINGH RATHORE  
 Reg. No. CA/2007/28162

SIGNATURE OF ARCHITECT  
 VIVEK SINGH RATHORE (CA/2007/28162)

TITLE:  
 BASEMENT FLOOR PLAN SHOWING DRAINAGE LAYOUT

PROJECT:

PLAN SHOWING CHANGES I/R/28 (2/31/20) OF K.M.C. BLDG. RULE 2009 FROM THE SANCTIONED PLAN VICE S.P. NO. 20/17/2006 DATED 11/11/19 FOR THE CONSTRUCTION OF A 4-STOREY RESIDENTIAL BUILDING AT PREMISES NO. 53, P. NO. 1234, ROAD WARD NO. 57, BOROUGH NO. VII, P.S. - TANGRA, KOLKATA-700016 HEIGHT 40M, U.S. 899A OF KOLKATA MUNICIPAL CORPORATION, ACT - 1988

ARCHITECTS

SCALE: 1:200  
 DATE: 26.08.17  
 CHECKED: SH

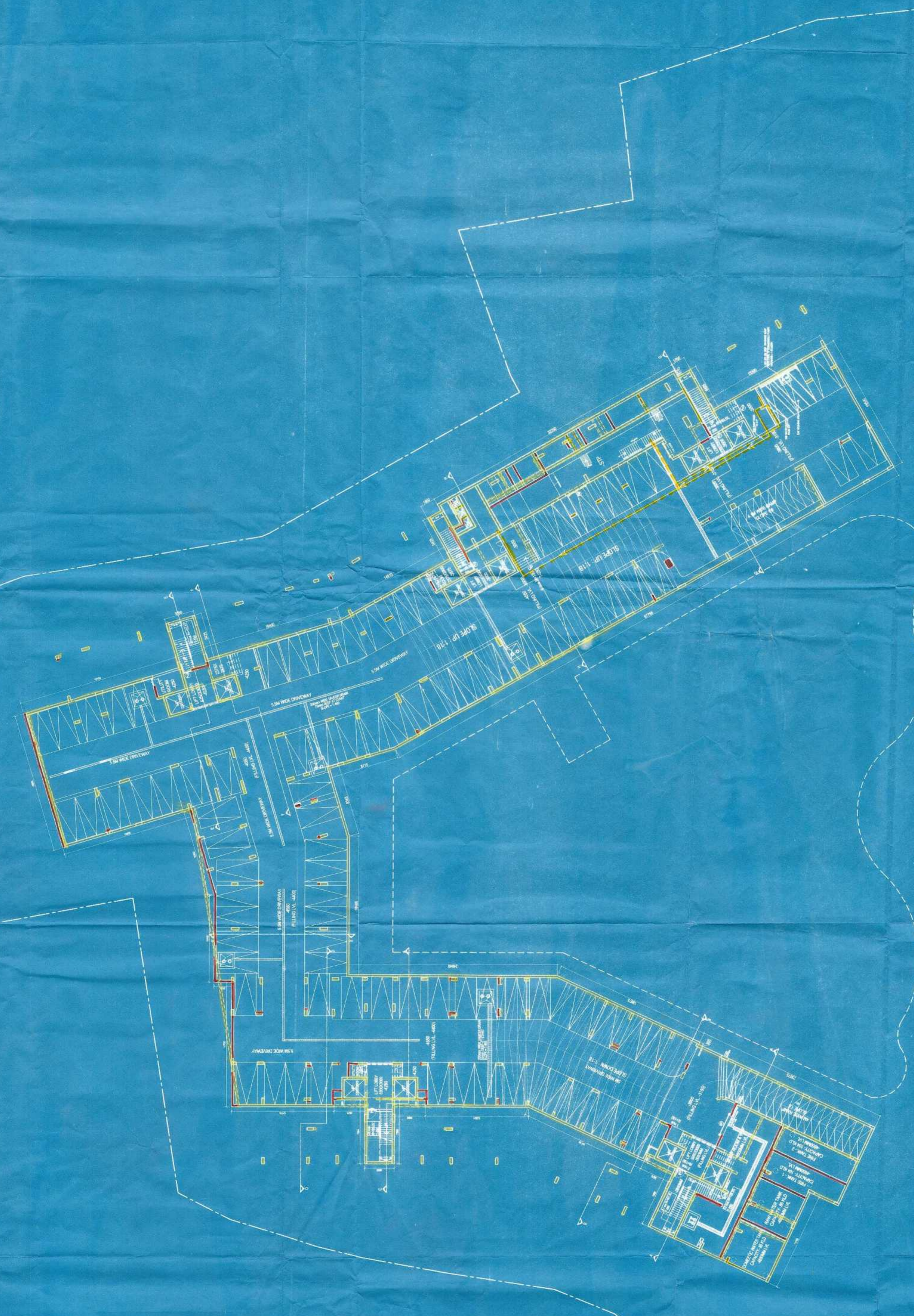

01 BASEMENT PLAN  
 SCALE - 1:200

150. C. 0000000000  
PARTY'S COPY

AGGRIAN INDUSTRIAL CORPORATION  
BUILDING DEPT.  
PLANS APPROVED FOR THE CONSTRUCTION OF  
BY D. 08.090 P.C. ENGINEER  
ON 08.09.09  
No. 02  
Assistant Engineer  
E. Eng. (C)

The Plans for the Construction of  
B. S. Plan No. 02/01/006  
Date: 21/11/11  
E. Engineer (C)  
D. 08.09.09  
E. Eng. (C)

OFFICE OF THE DEPUTY CHIEF ENGINEER  
DATE: 02/11/11  
THE REGULATORY AUTHORITY